

# FE COMMUNITY GARDENS

444 CENTRAL AVE,  
FORT ERIE, ONTARIO  
JANUARY 13, 2025

## DRAWING INDEX

OPTION 1 LAYOUT PLAN L101  
OPTION 2 LAYOUT PLAN L102  
DETAILS L201



KEY PLAN

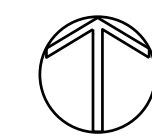



1 L101 CONTEXT MAP

SCALE 1:150

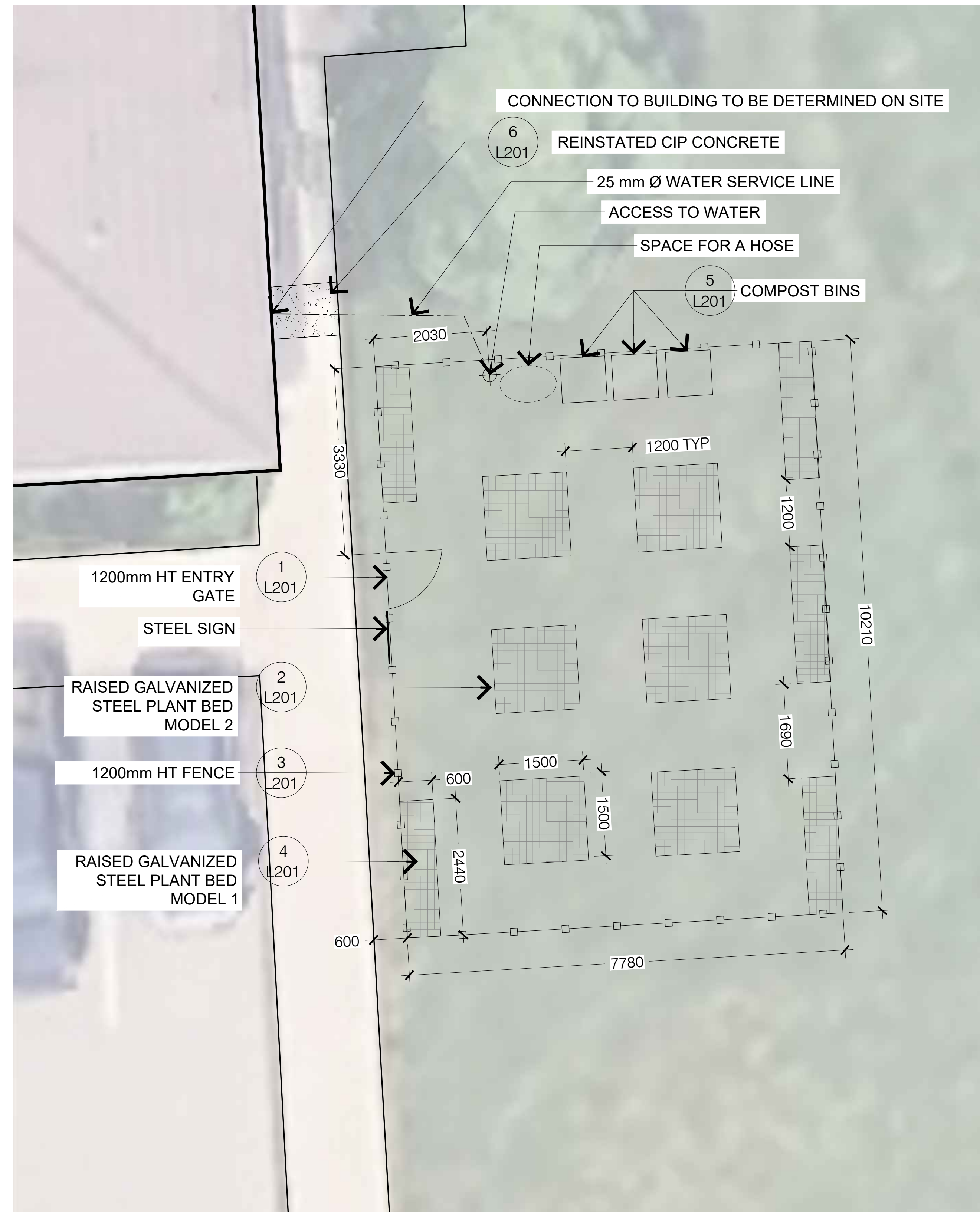
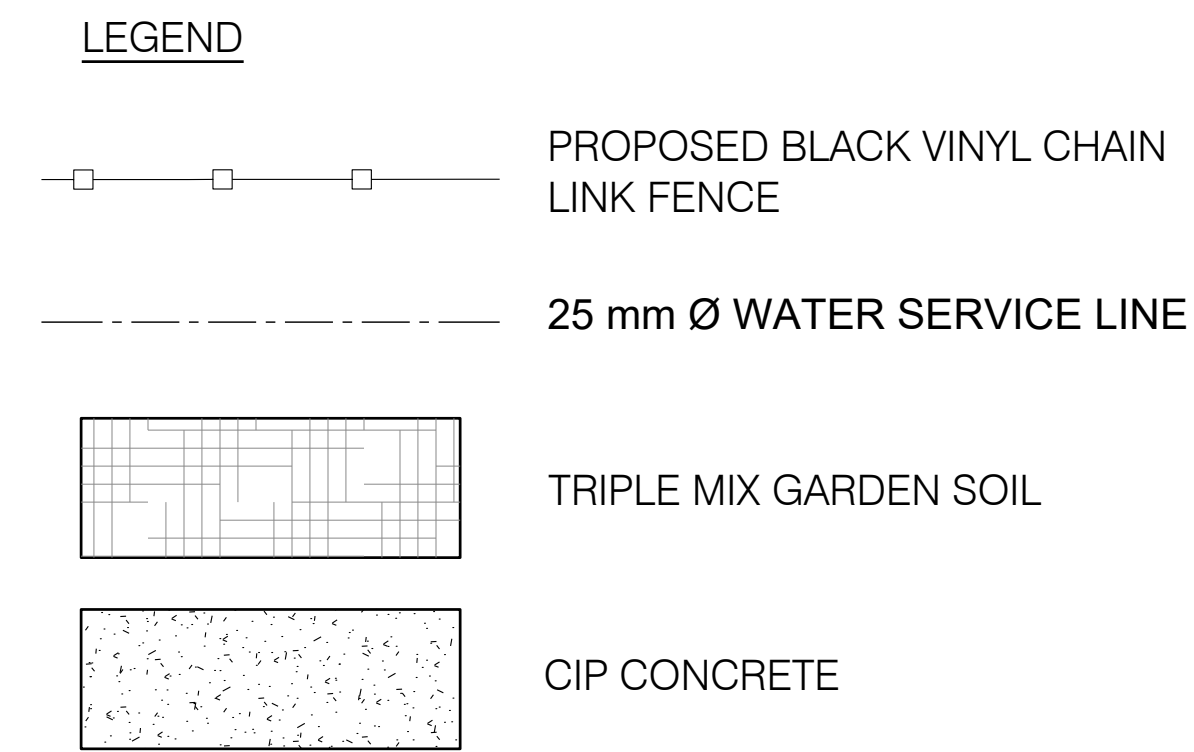

2 L101 LAYOUT PLAN



GENERAL NOTES:

- CONTRACTOR SHALL BE REQUIRED TO HAVE A FLAGMAN DIRECTING ALL DELIVERIES OF MACHINERY OR MATERIALS TO THE SITE.
- REINSTATE ALL AREAS AND ITEMS DAMAGED AS A RESULT OF CONSTRUCTION ACTIVITIES TO THE SATISFACTION OF THE TOWN STAFF, INCLUDING AREAS BEYOND THE PROPERTY LINE.
- CONTRACTOR SHALL REVIEW AND VERIFY SITE GRADES AND DIMENSIONS ON-SITE AND REPORT ANY DISCREPANCIES TO TOWN STAFF. COMMENCEMENT OF GRADING SHALL CONSTITUTE ACCEPTANCE OF SITE CONDITIONS; NO CLAIMS FOR EXTRAS WILL BE ENTERTAINED THEREAFTER.
- STORAGE OF MATERIALS, VEHICLES AND EQUIPMENT SHALL NOT BE PERMITTED WITHIN THE MUNICIPAL ROAD ALLOWANCE.
- CONTRACTOR SHALL BE RESPONSIBLE TO CLEAN ROADS DAILY TO THE SATISFACTION OF TOWN STAFF.
- SITE SHALL BE MAINTAINED IN A CLEAN AND ORDERLY STATE FOR THE DURATION OF CONSTRUCTION; ALL WORK SHALL BE PERFORMED IN ACCORDANCE WITH OCCUPATIONAL HEALTH AND SAFETY ACT.
- ALL TEMPORARY PROTECTIVE & SEDIMENT CONTROL FENCING SHALL BE MAINTAINED BY THE CONTRACTOR TO THE SATISFACTION OF TOWN STAFF FOR THE DURATION OF CONSTRUCTION.
- CONTRACTOR SHALL SUPPLY & INSTALL FILTER FABRIC PROTECTION ON ALL EXISTING CATCH BASINS, WATER METER CHAMBERS, AND UTILITIES.
- CONTRACTOR SHALL REPAIR AT HIS/HER COST ANY DAMAGE ARISING DURING CONSTRUCTION.
- ALL EXISTING VEGETATION TO BE PRESERVED SHALL BE PROTECTED BY THE GENERAL CONTRACTOR FOR THE DURATION OF CONSTRUCTION.
- ALL EXISTING UTILITIES SHOWN ON THE DRAWING ARE FOR REFERENCE PURPOSES ONLY. THE GENERAL CONTRACTOR SHALL CONTACT THE UTILITY COMPANIES FOR UTILITIES STAKEOUT. THE CONTRACTOR SHALL BE RESPONSIBLE FOR ANY DAMAGES CAUSED TO EXISTING UTILITIES DURING CONSTRUCTION.
- ALL CONSTRUCTION TO BE CARRIED OUT IN ACCORDANCE WITH THE MOST CURRENT PROVINCIAL STANDARDS AND SPECIFICATIONS.
- THE CONSTRUCTION OF CURBS, SIDEWALKS, STREET TREES AND UTILITIES LOCATED WITHIN THE R.O.W. SHALL BE REVIEWED AND DOCUMENTED.
- DUST CONTROL: CONTRACTOR SHALL TAKE ALL NECESSARY MEASURES TO CONTROL DUST ON THIS PROJECT SITE ON A DAILY BASIS AND TO THE SATISFACTION OF THE TOWN.
- CONTRACTOR TO PROVIDE DRAWINGS FOR ACCESS POINT AND STAGING OF MATERIALS FOR THE SITE.
- DO NOT SCALE DRAWING.
- REPORT ANY DISCREPANCIES PRIOR TO COMMENCING WORK. NO RESPONSIBILITY IS BORNE BY THE TOWN FOR UNKNOWN SUBSURFACE CONDITION.



Project Title  
FORT ERIE COMMUNITY GARDENS  
444 CENTRAL AVE.  
FORT ERIE, ON L2A 3T6

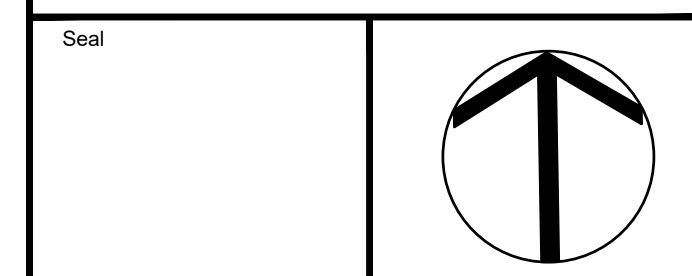

Drawing Title  
**OPTION 1**  
**LAYOUT PLAN**

Drawn	E.L.	Checked	KS
Date	2026-01-15	Drawing No.	L101
SCALED	AS NOTED		



1 L102 CONTEXT MAP

SCALE 1:150

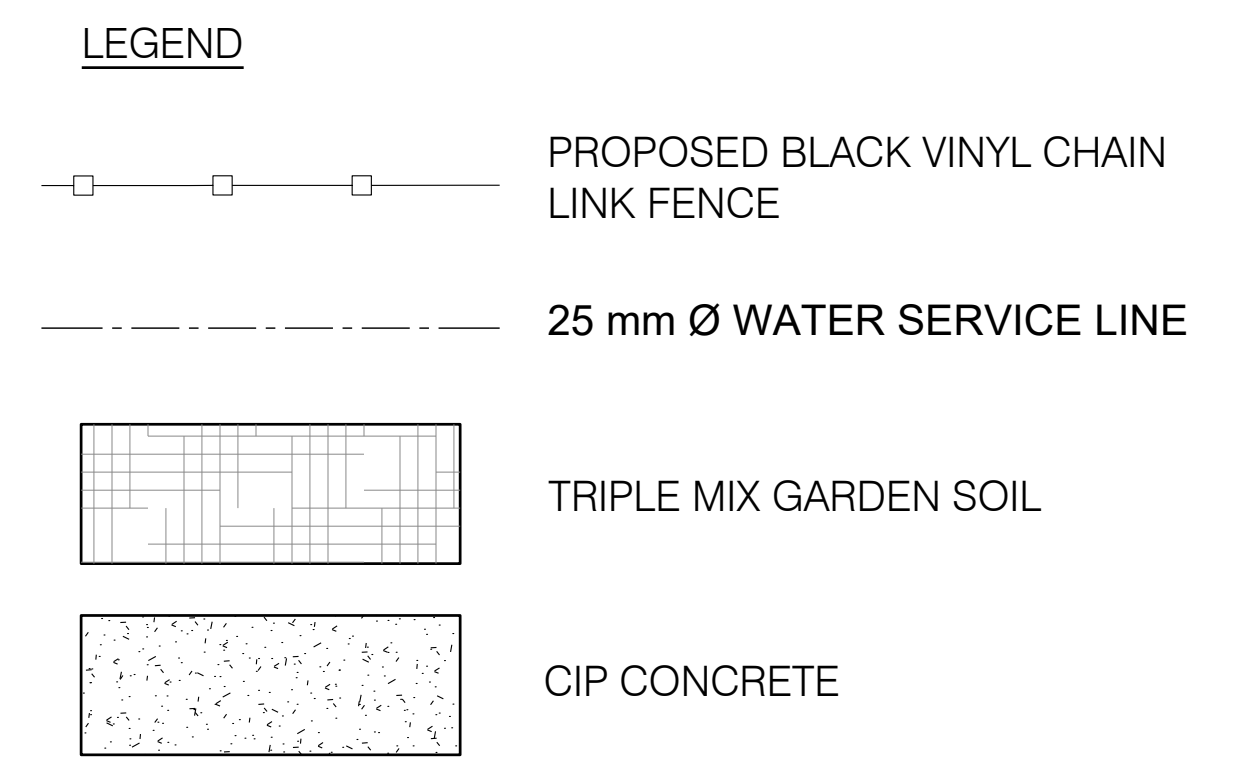

2 L102 LAYOUT PLAN

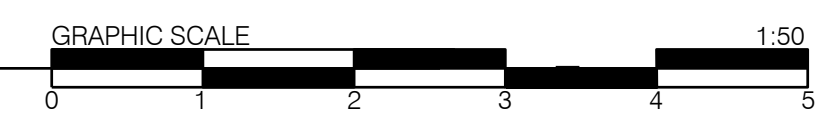

- GENERAL NOTES:
- CONTRACTOR SHALL BE REQUIRED TO HAVE A FLAGMAN DIRECTING ALL DELIVERIES OF MACHINERY OR MATERIALS TO THE SITE.
  - REINSTATE ALL AREAS AND ITEMS DAMAGED AS A RESULT OF CONSTRUCTION ACTIVITIES TO THE SATISFACTION OF THE TOWN STAFF, INCLUDING AREAS BEYOND THE PROPERTY LINE.
  - CONTRACTOR SHALL REVIEW AND VERIFY SITE GRADES AND DIMENSIONS ON-SITE AND REPORT ANY DISCREPANCIES TO TOWN STAFF. COMMENCEMENT OF GRADING SHALL CONSTITUTE ACCEPTANCE OF SITE CONDITIONS; NO CLAIMS FOR EXTRAS WILL BE ENTERTAINED THEREAFTER.
  - STORAGE OF MATERIALS, VEHICLES AND EQUIPMENT SHALL NOT BE PERMITTED WITHIN THE MUNICIPAL ROAD ALLOWANCE.
  - CONTRACTOR SHALL BE RESPONSIBLE TO CLEAN ROADS DAILY TO THE SATISFACTION OF TOWN STAFF.
  - SITE SHALL BE MAINTAINED IN A CLEAN AND ORDERLY STATE FOR THE DURATION OF CONSTRUCTION; ALL WORK SHALL BE PERFORMED IN ACCORDANCE WITH OCCUPATIONAL HEALTH AND SAFETY ACT.
  - ALL TEMPORARY PROTECTIVE & SEDIMENT CONTROL FENCING SHALL BE MAINTAINED BY THE CONTRACTOR TO THE SATISFACTION OF TOWN STAFF FOR THE DURATION OF CONSTRUCTION.
  - CONTRACTOR SHALL SUPPLY & INSTALL FILTER FABRIC PROTECTION ON ALL EXISTING CATCH BASINS, WATER METER CHAMBERS, AND UTILITIES.
  - CONTRACTOR SHALL REPAIR AT HIS/HER COST ANY DAMAGE ARISING DURING CONSTRUCTION.
  - ALL EXISTING VEGETATION TO BE PRESERVED SHALL BE PROTECTED BY THE GENERAL CONTRACTOR FOR THE DURATION OF CONSTRUCTION.
  - ALL EXISTING UTILITIES SHOWN ON THE DRAWING ARE FOR REFERENCE PURPOSES ONLY. THE GENERAL CONTRACTOR SHALL CONTACT THE UTILITY COMPANIES FOR UTILITIES STAKEOUT. THE CONTRACTOR SHALL BE RESPONSIBLE FOR ANY DAMAGES CAUSED TO EXISTING UTILITIES DURING CONSTRUCTION.
  - ALL CONSTRUCTION TO BE CARRIED OUT IN ACCORDANCE WITH THE MOST CURRENT PROVINCIAL STANDARDS AND SPECIFICATIONS.
  - THE CONSTRUCTION OF CURBS, SIDEWALKS, STREET TREES AND UTILITIES LOCATED WITHIN THE R.O.W. SHALL BE REVIEWED AND DOCUMENTED.
  - DUST CONTROL: CONTRACTOR SHALL TAKE ALL NECESSARY MEASURES TO CONTROL DUST ON THIS PROJECT SITE ON A DAILY BASIS AND TO THE SATISFACTION OF THE TOWN.
  - CONTRACTOR TO PROVIDE DRAWINGS FOR ACCESS POINT AND STAGING OF MATERIALS FOR THE SITE.
  - DO NOT SCALE DRAWING.
  - REPORT ANY DISCREPANCIES PRIOR TO COMMENCING WORK. NO RESPONSIBILITY IS BORNE BY THE TOWN FOR UNKNOWN SUBSURFACE CONDITION.



Project Title  
**FORT ERIE COMMUNITY GARDENS**  
 444 CENTRAL AVE.  
 FORT ERIE, ON L2A 3T6

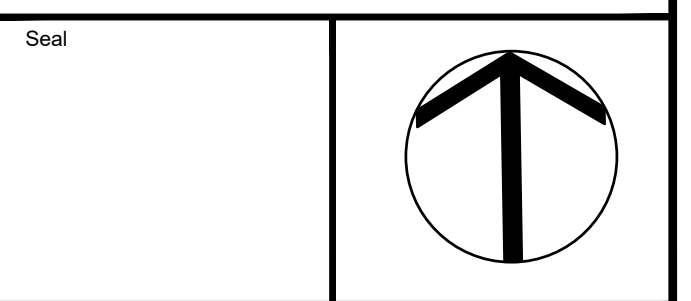

Drawing Title  
**OPTION 2  
 LAYOUT PLAN**

Drawn	E.L.	Checked	KS
-------	------	---------	----

Date	2026-01-15	Drawing No.	<b>L102</b>
SCALED	AS NOTED		

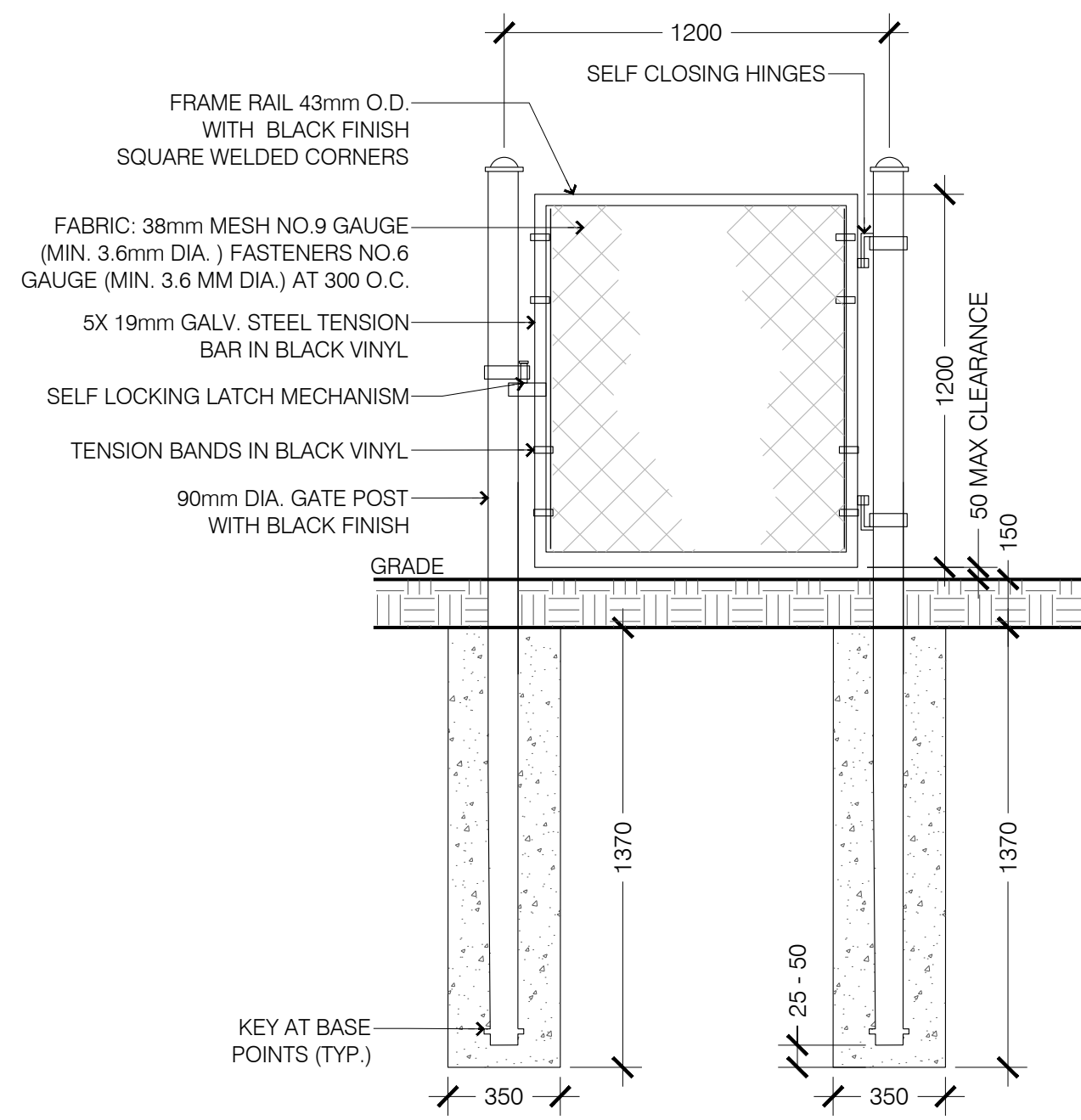

1 1200mm HT ENTRY GATE  
L201

SCALE 1:20

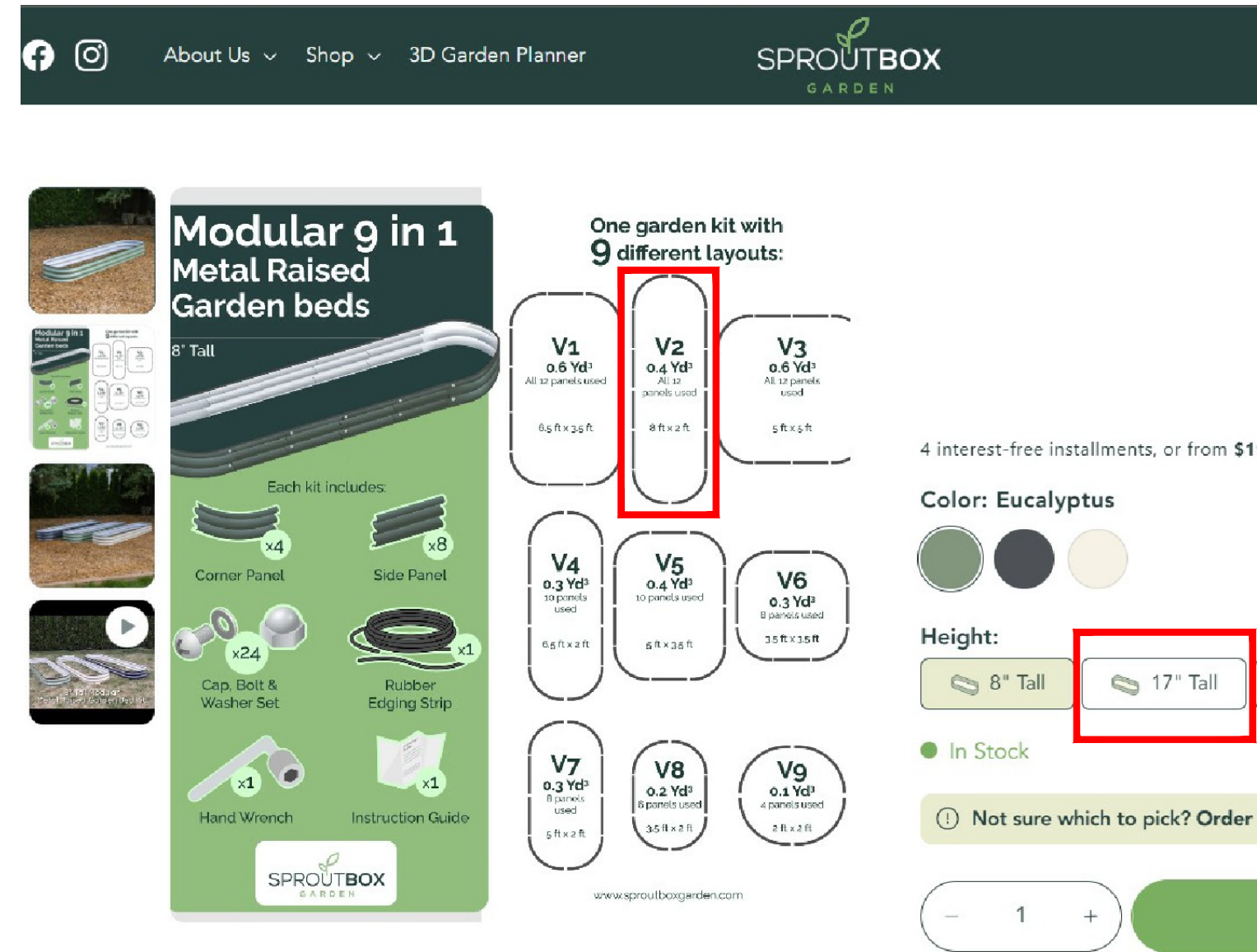

2 17" RAISED GALVANIZED STEEL PLANT BED MODEL 1  
L201

N.T.S.

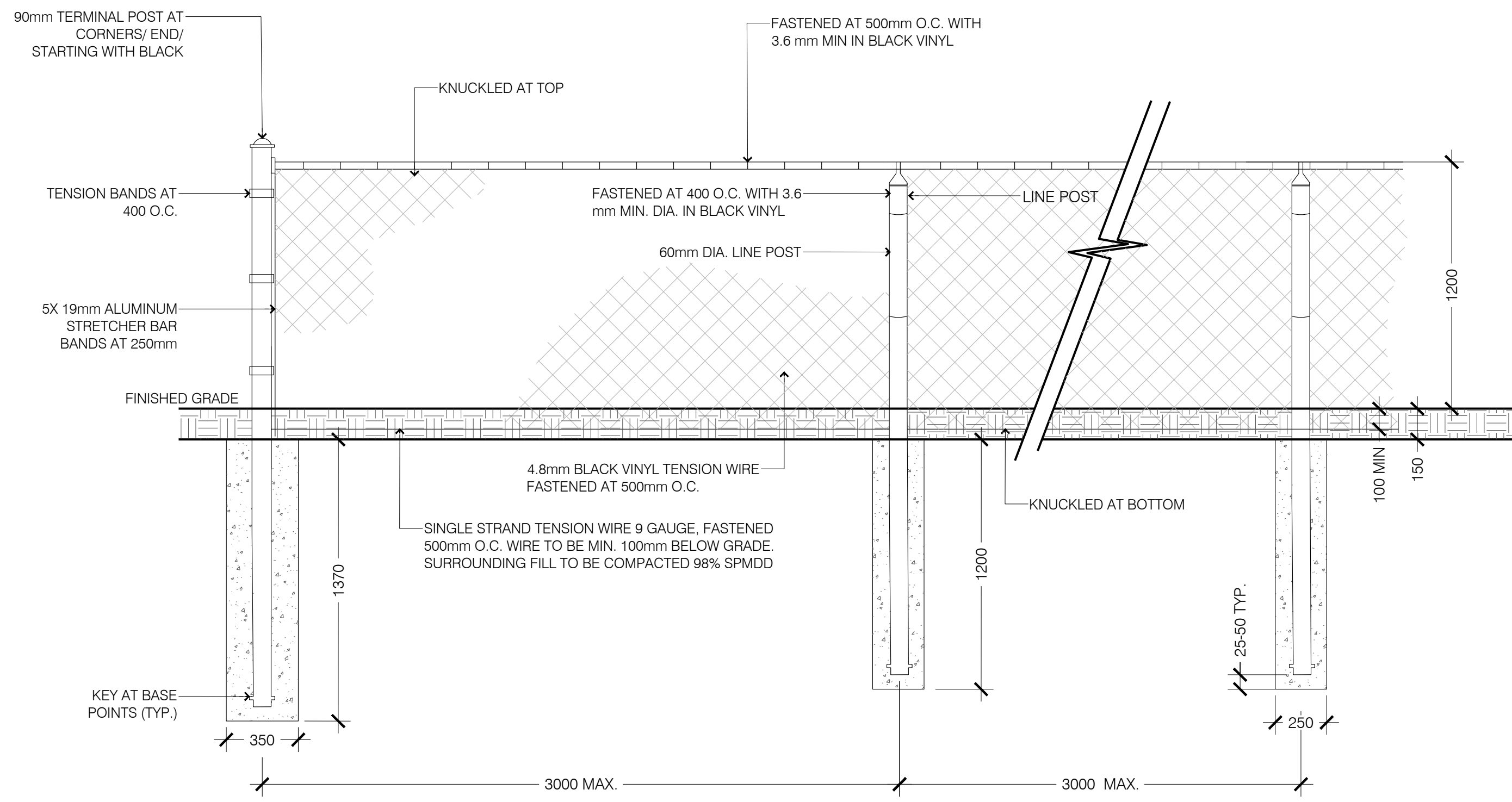

3 RAISED GALVANIZED STEEL PLANT BED MODEL 2  
L201

SCALE 1:20

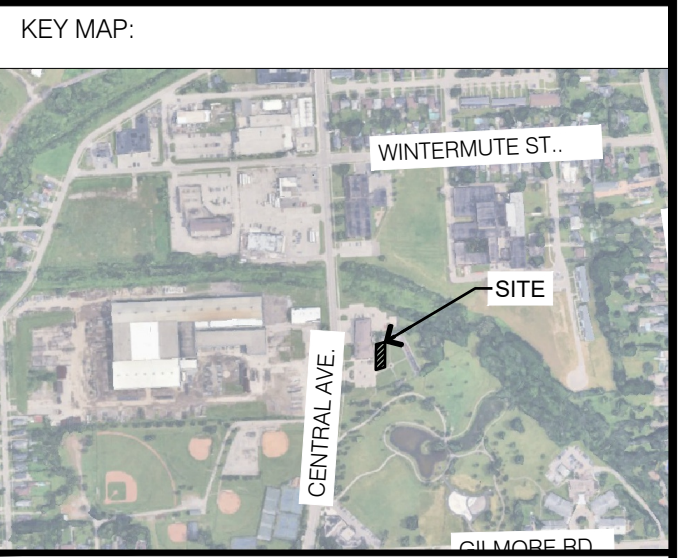

GENERAL NOTES:

- CONTRACTOR SHALL BE REQUIRED TO HAVE A FLAGMAN DIRECTING ALL DELIVERIES OF MACHINERY OR MATERIALS TO THE SITE.
- REINSTATE ALL AREAS AND ITEMS DAMAGED AS A RESULT OF CONSTRUCTION ACTIVITIES TO THE SATISFACTION OF THE TOWN STAFF, INCLUDING AREAS BEYOND THE PROPERTY LINE.
- CONTRACTOR SHALL REVIEW AND VERIFY SITE GRADES AND DIMENSIONS ON-SITE AND REPORT ANY DISCREPANCIES TO TOWN STAFF. COMMENCEMENT OF GRADING SHALL CONSTITUTE ACCEPTANCE OF SITE CONDITIONS; NO CLAIMS FOR EXTRAS WILL BE ENTERTAINED THEREAFTER.
- STORAGE OF MATERIALS, VEHICLES AND EQUIPMENT SHALL NOT BE PERMITTED WITHIN THE MUNICIPAL ROAD ALLOWANCE. CONTRACTOR SHALL BE RESPONSIBLE TO CLEAN ROADS DAILY TO THE SATISFACTION OF TOWN STAFF.
- SITE SHALL BE MAINTAINED IN A CLEAN AND ORDERLY STATE FOR THE DURATION OF CONSTRUCTION; ALL WORK SHALL BE PERFORMED IN ACCORDANCE WITH OCCUPATIONAL HEALTH AND SAFETY ACT.
- ALL TEMPORARY PROTECTIVE & SEDIMENT CONTROL FENCING SHALL BE MAINTAINED BY THE CONTRACTOR TO THE SATISFACTION OF TOWN STAFF FOR THE DURATION OF CONSTRUCTION.
- CONTRACTOR SHALL SUPPLY & INSTALL FILTER FABRIC PROTECTION ON ALL EXISTING CATCH BASINS, WATER METER CHAMBERS, AND UTILITIES.
- CONTRACTOR SHALL REPAIR AT HIS/HER COST ANY DAMAGE ARISING DURING CONSTRUCTION.
- ALL EXISTING VEGETATION TO BE PRESERVED SHALL BE PROTECTED BY THE GENERAL CONTRACTOR FOR THE DURATION OF CONSTRUCTION.
- ALL EXISTING UTILITIES SHOWN ON THE DRAWING ARE FOR REFERENCE PURPOSES ONLY. THE GENERAL CONTRACTOR SHALL CONTACT THE UTILITY COMPANIES FOR UTILITIES STAKEOUT. THE CONTRACTOR SHALL BE RESPONSIBLE FOR ANY DAMAGES CAUSED TO EXISTING UTILITIES DURING CONSTRUCTION.
- ALL CONSTRUCTION TO BE CARRIED OUT IN ACCORDANCE WITH THE MOST CURRENT PROVINCIAL STANDARDS AND SPECIFICATIONS.
- THE CONSTRUCTION OF CURBS, SIDEWALKS, STREET TREES AND UTILITIES LOCATED WITHIN THE R.O.W. SHALL BE REVIEWED AND DOCUMENTED.
- DUST CONTROL: CONTRACTOR SHALL TAKE ALL NECESSARY MEASURES TO CONTROL DUST ON THIS PROJECT SITE ON A DAILY BASIS AND TO THE SATISFACTION OF THE TOWN.
- CONTRACTOR TO PROVIDE DRAWINGS FOR ACCESS POINT AND STAGING OF MATERIALS FOR THE SITE.
- DO NOT SCALE DRAWING.
- REPORT ANY DISCREPANCIES PRIOR TO COMMENCING WORK. NO RESPONSIBILITY IS BORNE BY THE TOWN FOR UNKNOWN SUBSURFACE CONDITION.

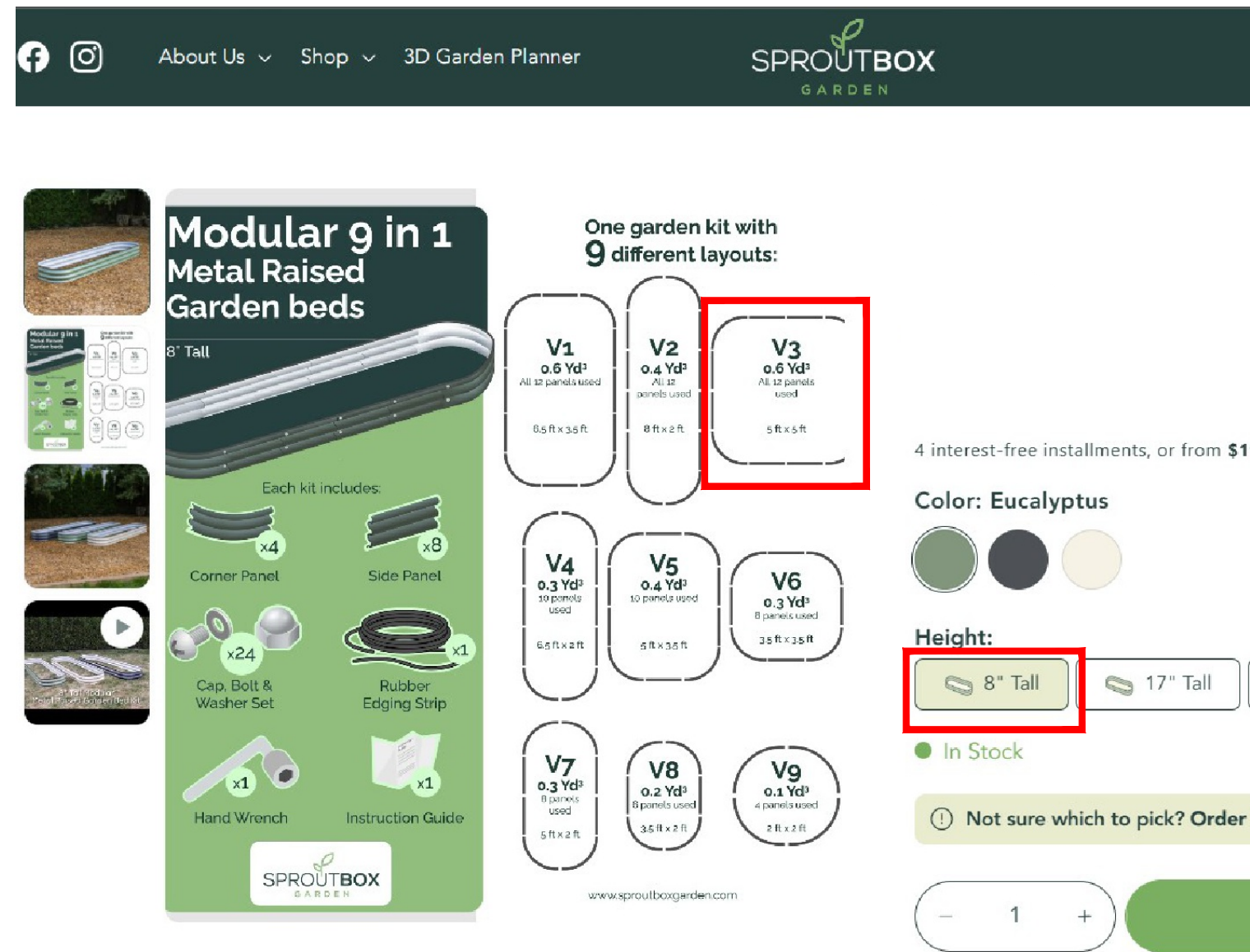

4 8" RAISED GALVANIZED STEEL PLANT BED MODEL 2  
L201

N.T.S.



5 COMPOST BINS  
L201

N.T.S.

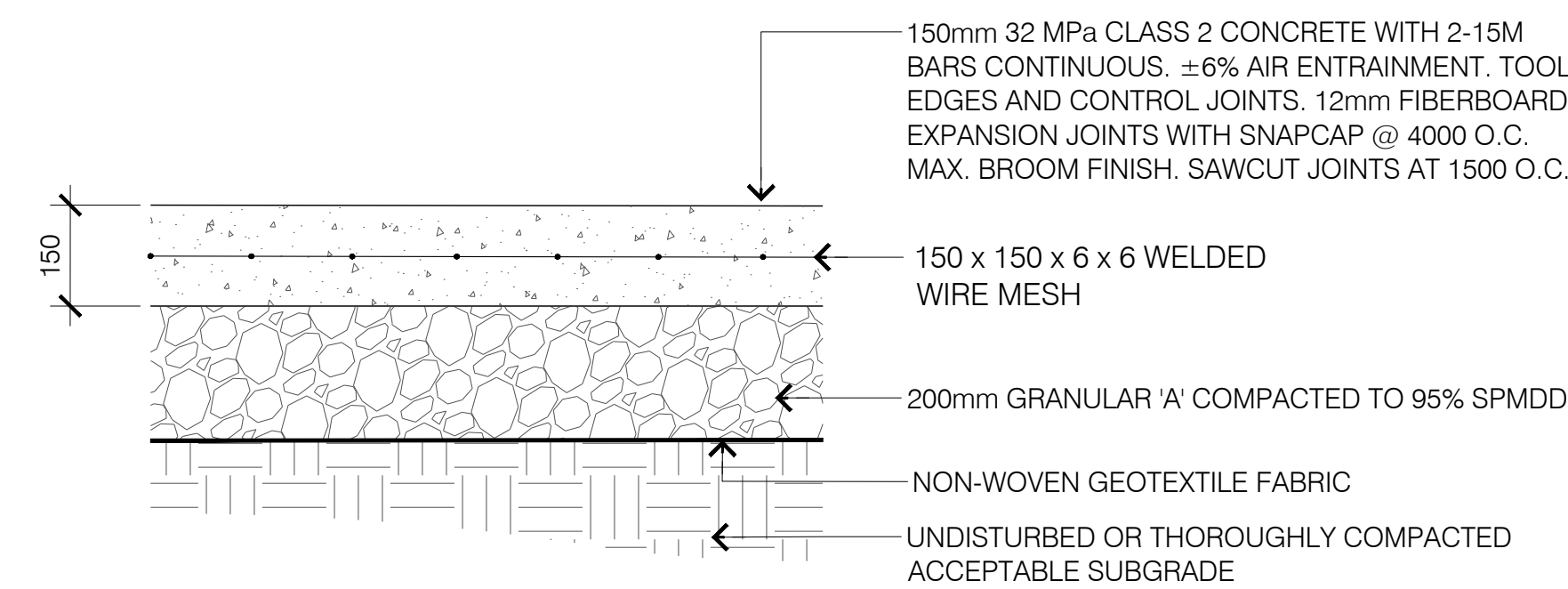

6 CIP CONCRETE  
L201

SCALE 1:20



Project Title  
FORT ERIE COMMUNITY GARDENS  
444 CENTRAL AVE.  
FORT ERIE, ON L2A 3T6

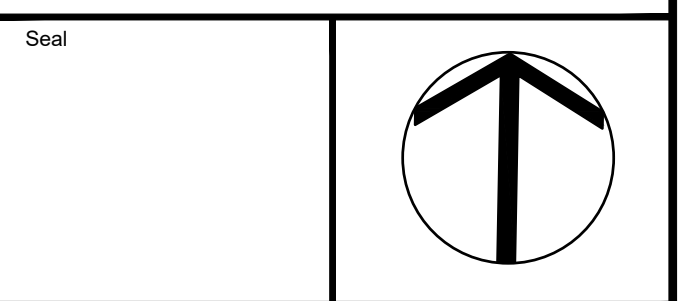

Drawing Title  
DETAILS

Drawn	E.L.	Checked	KS
Date	2026-01-15	Drawing No.	L201
SCALE	AS NOTED		