

NOTE: THIS SKETCH IS NOT A PLAN OF SURVEY

SKETCH FOR PLANNING PURPOSES ONLY

285 ELMWOOD AVENUE
 TOWN OF FORT ERIE
 REGIONAL MUNICIPALITY OF NIAGARA



J.D. BARNES LIMITED
 © COPYRIGHT 2022

METRIC NOTE
 DISTANCES SHOWN ON THIS PLAN ARE IN METRES AND CAN BE CONVERTED TO FEET BY DIVIDING BY 0.3048

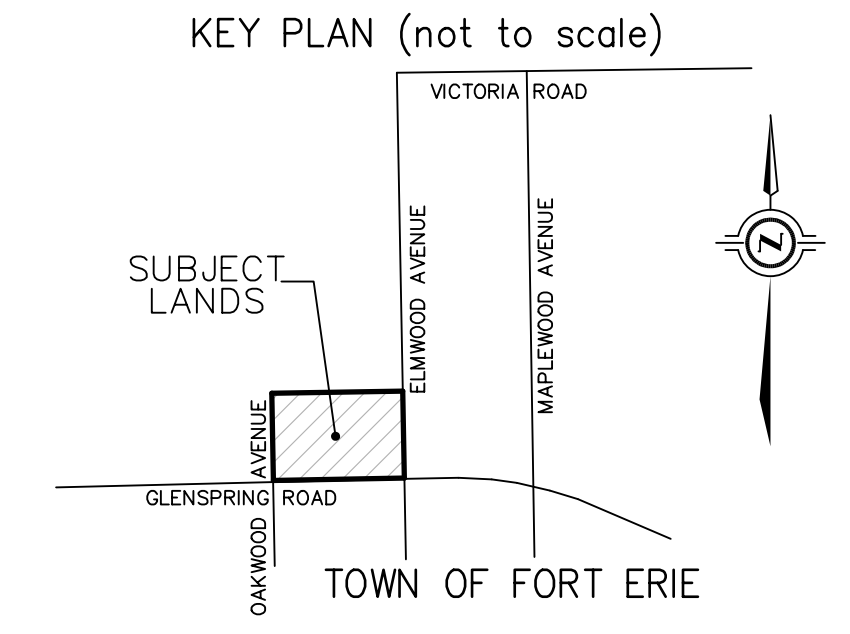

LEGAL DESCRIPTION

LOTS 263, 264 & 265, PART OF LOT 262, REGISTERED PLAN 402

BOUNDARY INFORMATION HAS BEEN DERIVED FROM AVAILABLE RECORDS AND FIELD MEASUREMENTS. THIS IS NOT A PLAN OF SURVEY.

DECEMBER 6, 2022
 DATE

ROY S. BARKUP
 ONTARIO LAND SURVEYOR

CAUTION

(A) THIS IS NOT A PLAN OF SURVEY AND SHALL NOT BE USED EXCEPT FOR THE PURPOSE INDICATED IN THE TITLE BLOCK.

(B) THIS SKETCH IS PROTECTED BY COPYRIGHT.

J.D. BARNES LIMITED
 SURVEYING MAPPING GIS
 LAND INFORMATION SPECIALISTS
 4318 PORTAGE ROAD - UNIT 2, NIAGARA FALLS, ON L2E 6A4
 T: (905) 358-3693 F: (905) 358-6224 www.jdbarnes.com

TW	DRAWN
RSK	CHECKED
DATED: 2022/12/06	
Ref. No. 22-16-363-00	

G:\2022\22-16-363\00\Drawing\22-16-363-00 calcs.dgn
 12/7/2022
 PLOTTED